

9049UF
3-hole "u" support for
1-5/8" x 13/16" strut

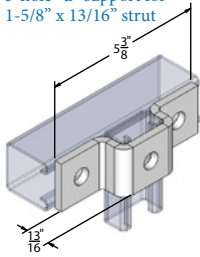

Materials/Finishes:	Zinc Plated (9049UFZ)
Thickness:	1/4"
Hole Dim:	9/16"
Wgt. each (lbs)	.70

9050UF
3-hole "u" support for
1-5/8" x 1" strut

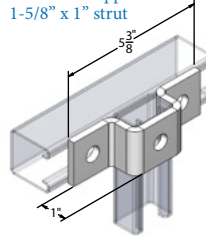

Materials/Finishes:	Zinc Plated (9050UFZ)
Thickness:	1/4"
Hole Dim:	9/16"
Wgt. each (lbs)	.71

9051UF
3-hole "u" support for
1-5/8" x 1-3/8" strut

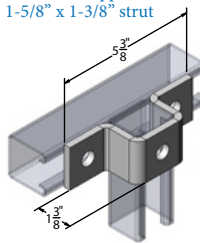

Materials/Finishes:	Zinc Plated (9051UFZ)
Thickness:	1/4"
Hole Dim:	9/16"
Wgt. each (lbs)	.84

9052UF
4-hole splice clevis for
1-5/8" x 1-5/8" strut

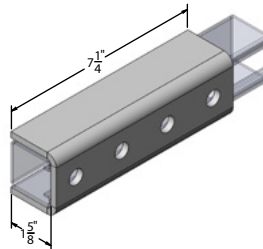

Materials/Finishes:	Zinc Plated (9052UFZ)
Thickness:	1/4"
Hole Dim:	9/16"
Wgt. each (lbs)	2.33

9053UF
5-hole "u" support for
1-5/8" x 1-5/8" strut

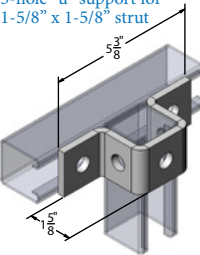

Materials/Finishes:	Zinc Plated (9053UFZ)
Thickness:	1/4"
Hole Dim:	9/16"
Wgt. each (lbs)	.85

9054UF
adjustable 1-hole, 2-slot
"u" support for
1-5/8" x 1-5/8" strut

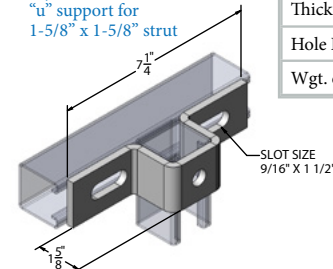

Materials/Finishes:	Zinc Plated (9054UFZ)
Thickness:	1/4"
Hole Dim:	9/16"
Wgt. each (lbs)	1.03

9055UF
6-hole "u" support for
1-5/8" double strut

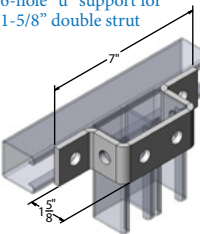

Materials/Finishes:	Zinc Plated (9055UFZ)
Thickness:	1/4"
Hole Dim:	9/16"
Wgt. each (lbs)	1.05

9056UF
3-hole "u" support for
1-5/8" x 2-7/16" strut

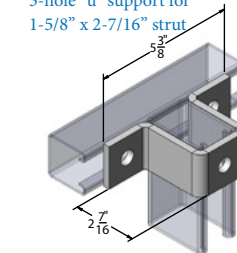

Materials/Finishes:	Zinc Plated (9056UFZ)
Thickness:	1/4"
Hole Dim:	9/16"
Wgt. each (lbs)	1.08

9057UF
7-hole "u" support for
1-5/8" x 3-1/4" strut

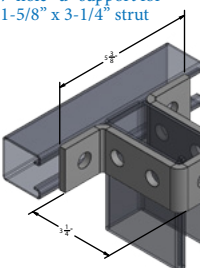

Materials/Finishes:	Zinc Plated (9057UFZ)
Thickness:	1/4"
Hole Dim:	9/16"
Wgt. each (lbs)	1.26

PROJECT INFORMATION			APPROVAL STAMP
Project:		Notes:	
Address:			
Contractor:			
Engineer:			
Date:			
Approved	Approved as Noted	Not Approved	